

**SPECIFICATION**

Current Rating:3A AC/DC  
 Voltage Raing:250V AC/DC  
 Withstand Voltage:1000V AC/Minute  
 Insulation Resistance:500 Megohms Min.  
 Temperature Range:-25°C To +85°C  
 Applicable Wire:AWG#22~28  
 Contact:Phosphor Bronze,Tin Plated  
 O.D. Of Wire Insulation:1.2~1.8  
 RoHS Compliant

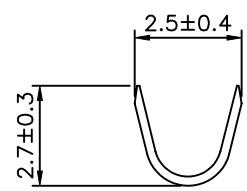

Section A-A

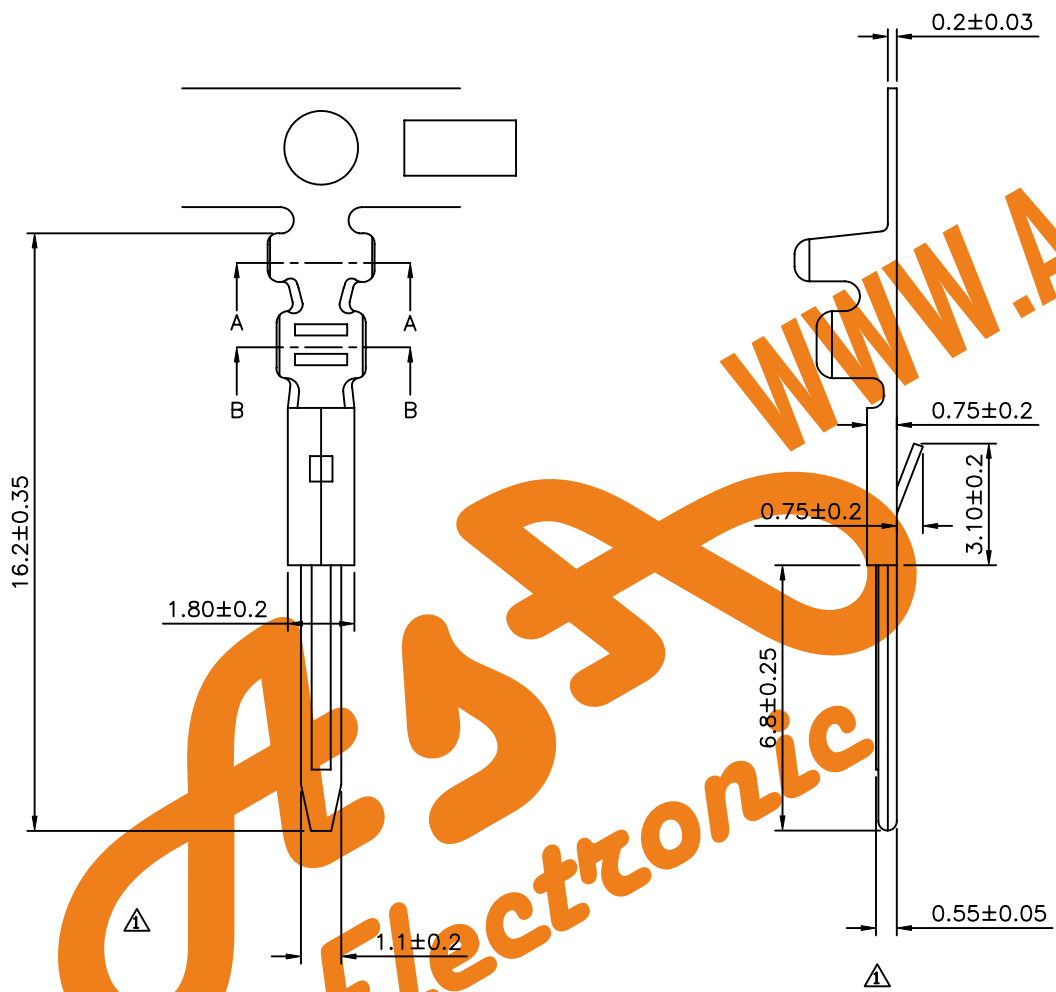
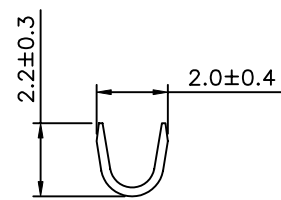

Section B-B



Tel : (+98) 21 66 73 56 82 Mob : (+98) 912 03 161 02

**Telegram:09396994470**

DRAWING No.		APPROVED BY		UNLESS OTHERWISE SPECIFIED TOLERANCES ARE .X ±0.38 .XX ±0.25				
01797		MEI						
		CHECKED BY						
		HZF						
		DRAWING BY						
		XYH						
SCALE	NONE	REV.	A1	UNIT	mm			
NO.	REV.	REVISIONS		CHK		DATE		